



Situatia existenta
 S teren = 25 mp
 Sc = 0,00mp
 Sd = 0,00mp

Situatia propusa
 S teren = 25 mp
 Sc = 3,80mp
 Sd = 3,80mp
 S. ocupata
 de containere = 3,80mp

Legenda

 Platforma Containere
 impamantate (1 buc) - 1,95mx1,95m

 Finisaj pavele si borduri

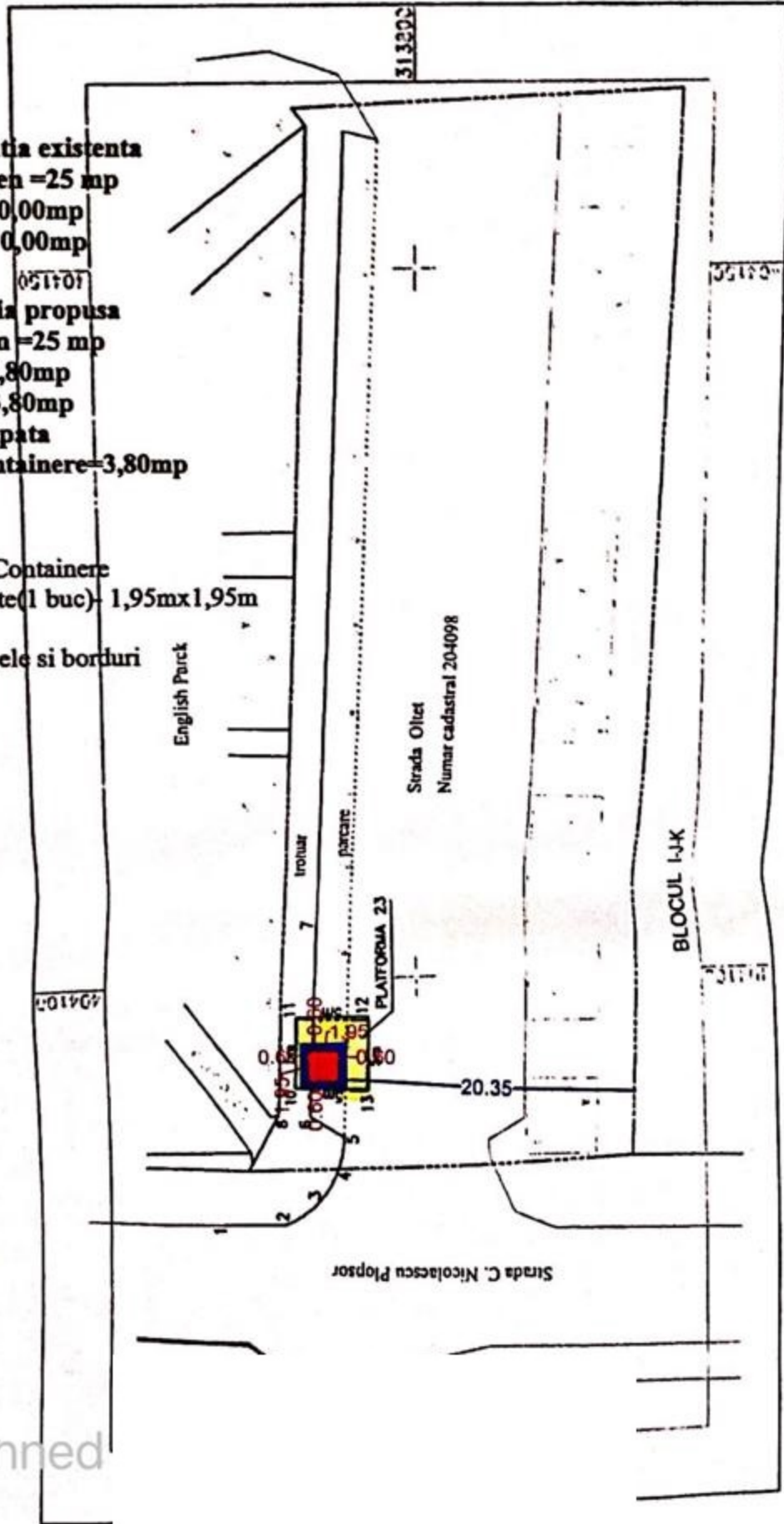

Plan de situatie Scara 1 500

Suprafata masurata (Cnp)	Adresa imobilului
25	PLATFORMA 23 Str. OLTEI BL.49 APARTAMENTE COLT CU ENGLISH PARK
	UAT
	Crolova

Data 03.01.2017
 Executant ILIESCU Dumitru

INVENTAR DE COORDONATE PLATFORMA 23

Nr. Pct.	Coordonate pct. de contur		Lungimi latari D(i, i+1)
	X [m]	Y [m]	
10	313808.553	404092.393	5.001
11	313808.336	404097.389	5.001
12	313803.342	404097.133	5.000
13	313803.342	404097.133	5.000

S(1Cc) = 25.00mp P = 20.001m

PRIMARIA CRANOVA
 DIRECTIA PATRIMONIULUI
 SERVICIUL PATRIMONIULUI

CONFORM CU ORIGINALUL

Vedere frontala

5 Mc.

748

trotuar de garda
cu panta 2° in
jurul
containerelor

1200

2°

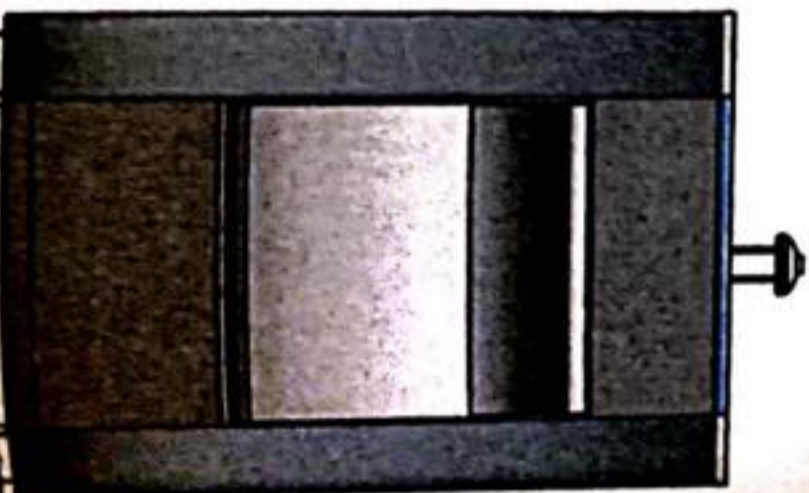

Vedere Posteroara

5 Mc.

748

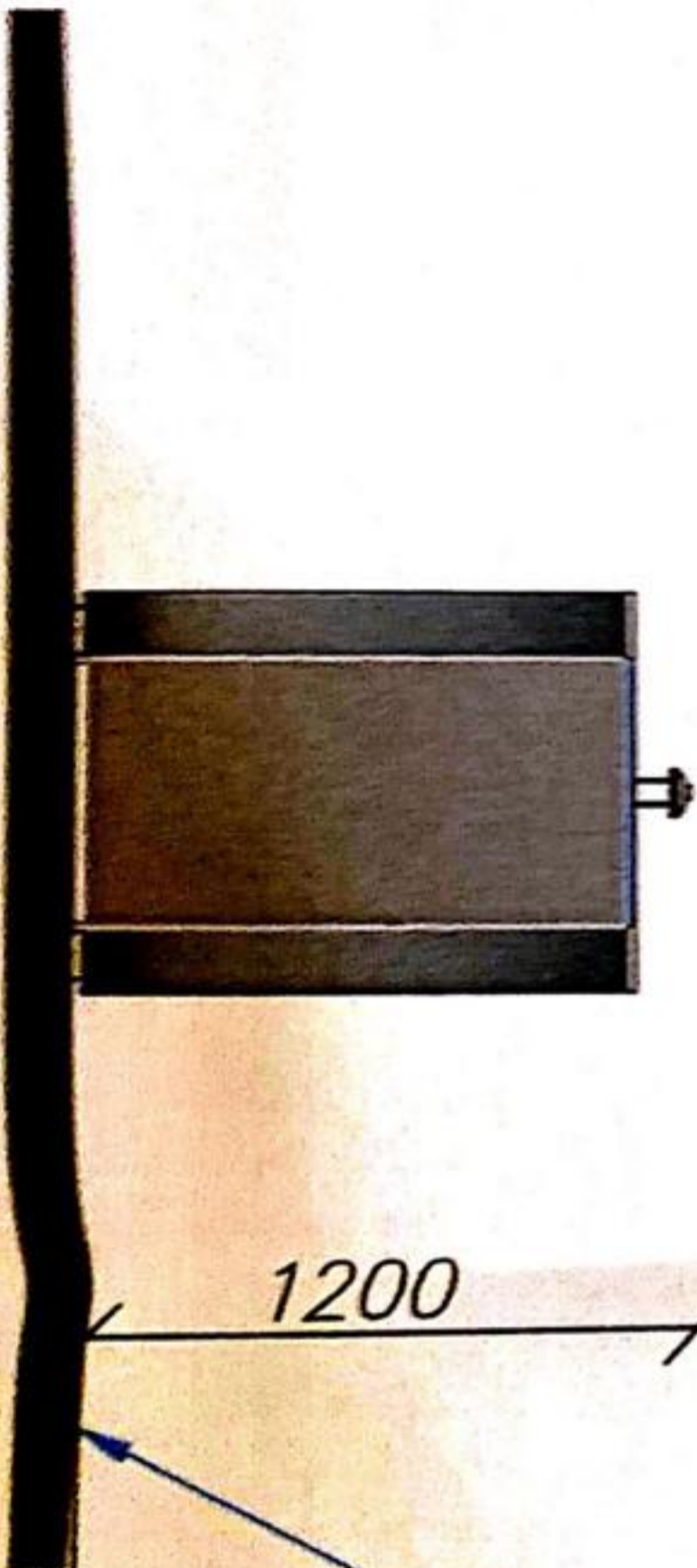

troțuar de garda
cu panta 2° in
jurul
containerelor

2.0°

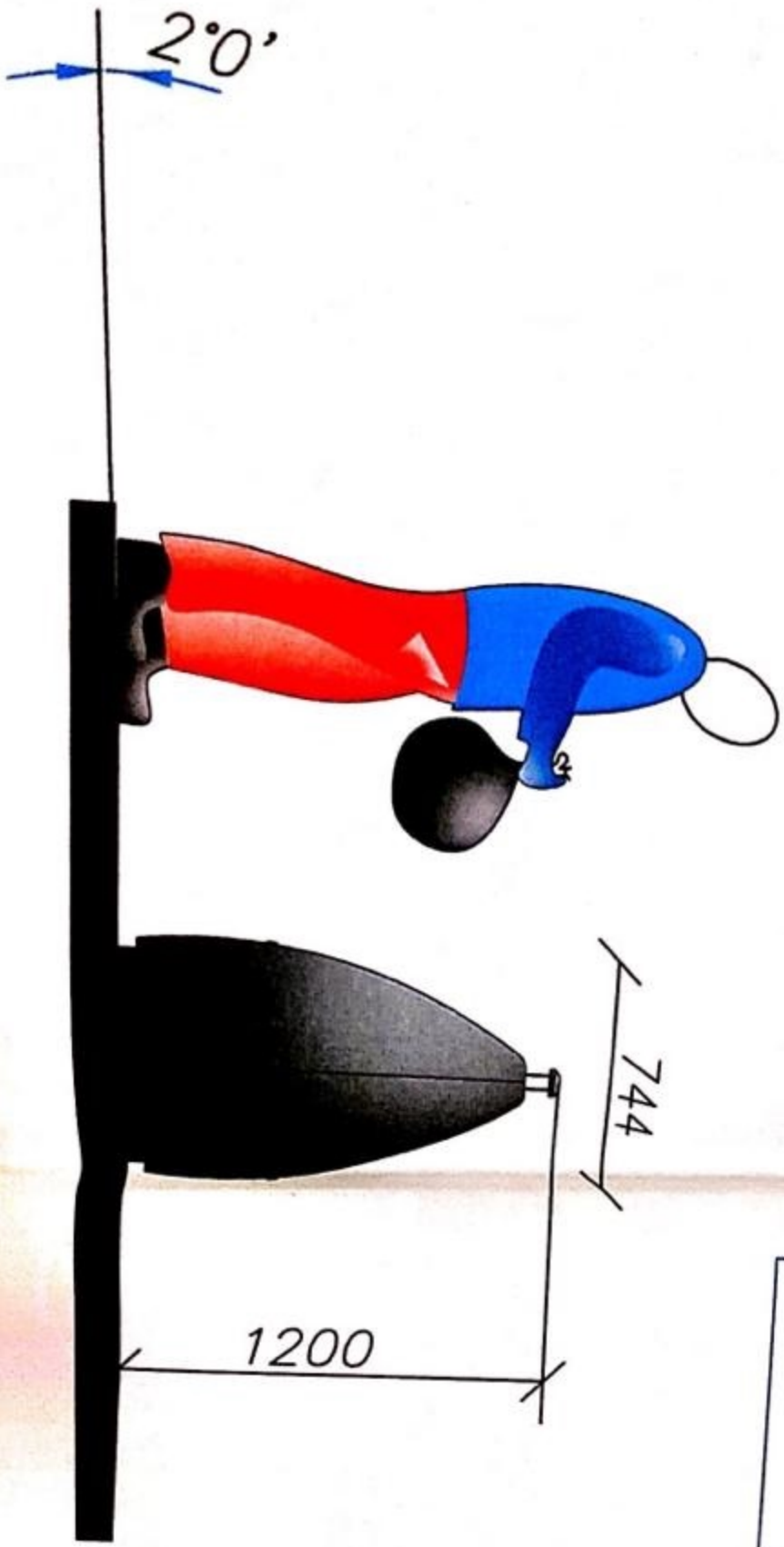

Vedere Laterala dreapta

5 Mc.

Vedere Laterala stanga

5 Mc.

