

PLAN URBANISTIC DE DETALIU - ALEEA 3 PLOPULUI NR. 15

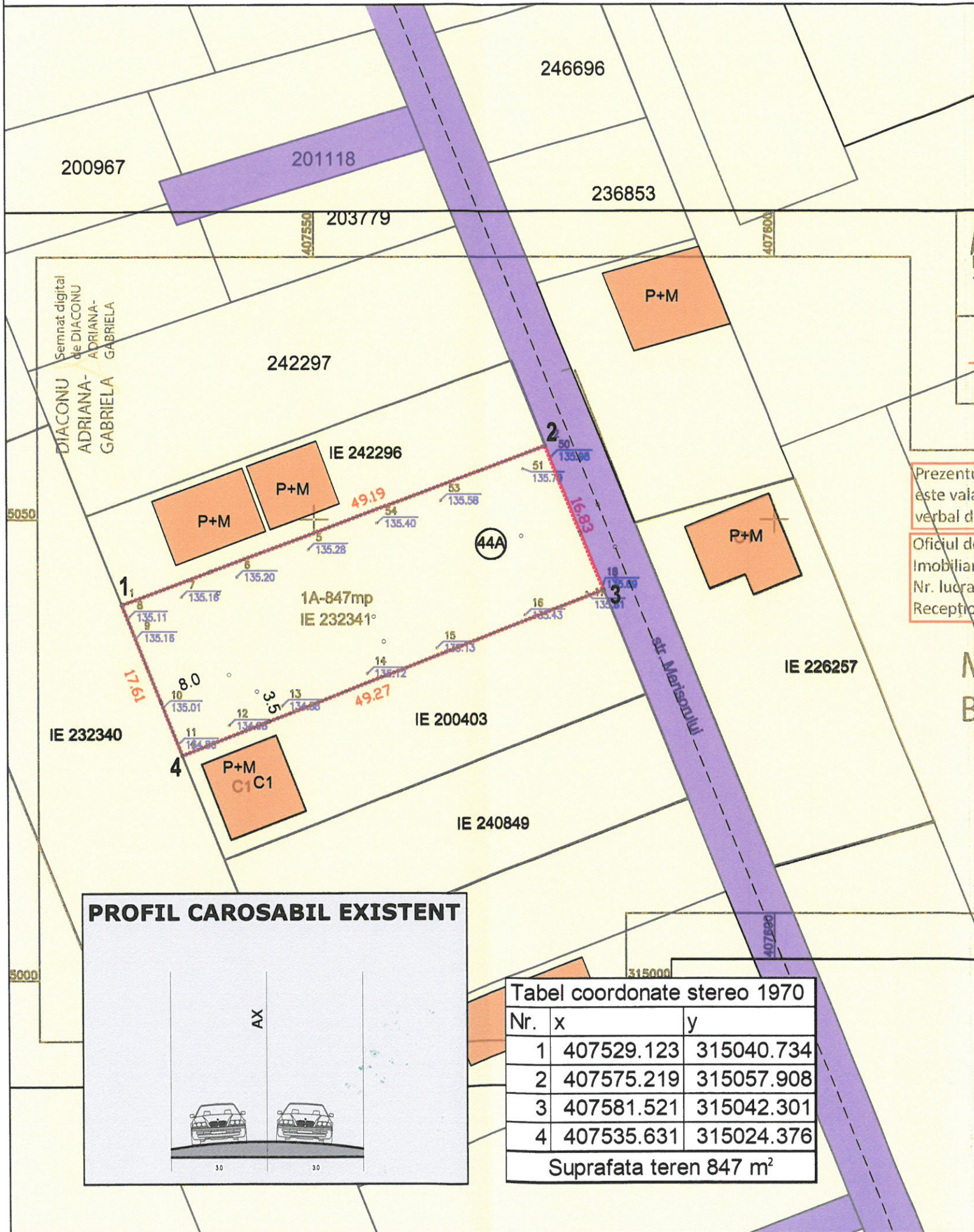

LEGENDA

LIMITE



Limita teren ce a generat PUD

Zonificare functionala

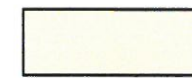

Locuire



Constructii existente

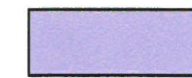

Circulatie carosabila

Prezentul este valabil verbal de Oficiul de Imobiliară Nr. lucrare Reception

Indicatori urbanistici conform PUG Mun. Craiova

Rh max - P+2

POT max - 35%

CUT max - 1.05

PROFIL CAROSABIL EXISTENT

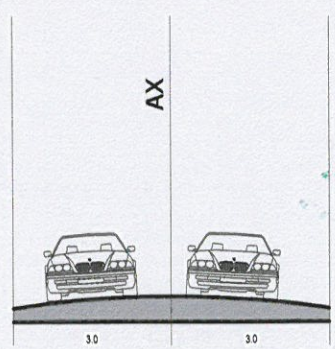

Tabel coordonate stereo 1970

Nr.	x	y
1	407529.123	315040.734
2	407575.219	315057.908
3	407581.521	315042.301
4	407535.631	315024.376

Suprafata teren 847 m²

DUMYS ARHITECTURA S.R.L.

Mun. Craiova, Str. Sararilor Nr. 31, Jud. Dolj
CUI 40871461

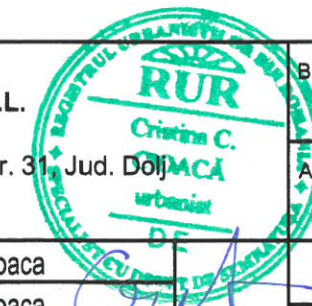

BENEFICIAR:

Zmarandache Costinel
Str. Dimbovita Nr. 27, Bl. 41, Sc. 1, Ap. 15

PROIECT NR.

AMPLASAMENT:

Aleea 3 Plopului nr. 15, Mun. Craiova, Jud. Dolj

SEF PROIECT

Urb. Cristina Cioaca

Scara:

1:500

Zonificare functionala - existent

Faza:

PUD

PROIECTAT

Urb. Cristina Cioaca

Data:

12.2021

U2

DESENAT

c. Arh. Sorin Dumitrascu